

The logo for Interlake Maritime Services features a stylized black and orange ship icon to the left of the word "Interlake" in a large, black, serif font. Below "Interlake" is the text "MARITIME SERVICES" in a smaller, blue, sans-serif font, with a blue wavy line graphic above it.

Interlake

MARITIME SERVICES



The Jones Act

The U.S. Merchant Marine is a vital part of the domestic maritime industry and is recognized as
"The Fourth Arm of National Defense."

US Built US Owned US Crewed

Indeed, a strong domestic fleet ensures the United States will always have:

World-class vessels to meet sealift needs;

1. Expert and experienced seafarers to man the U.S. government's organic surge sealift ships in times of national emergency;
2. A modern shipyard industrial base that is critical to the nation's economic, national, and homeland security; and
3. Intermodal transportation systems available for defense use through the Voluntary Intermodal Sealift Agreement (VISA).

Homeland Security

Economic Security

National Security

Barker/Tregurtha Families



The
Moran
Towing
Company



Mark Barker
President

Ted Tregurtha
President

James A Barker
President

Mormac
Marine Co.

The Interlake
Steamship Company

Interlake
LOGISTICS SOLUTIONS

Lake Michigan
CARFERRY

Interlake
PORT SERVICES

Ship Docking
LNG Ship Docking
Towing
Bulk and Oil Barges



Moran
Environmental
Recovery

Passenger Service
Atlantic Highlands, NJ To NYC
New Bedford, MA To
Martha's Vineyard

Currently Support Company
Operated Tankers
and LNG Carriers
Managed Ready Reserve
Vessels



Moran Towing Co. Founded in 1860

- Transportation
 - Oil and Gas
 - Bulk Materials
 - Specialty
- Ship Docking
 - Harbor Assist
 - LNG
 - Navy

seastreak

High Speed fast ferry commuter service between
NJ and NY and seasonal service in
Massachusetts, Rhode Island and North Carolina



Massachusetts (Seasonal):

- New Bedford ↔ Martha's Vineyard
- New Bedford ↔ Nantucket
- NJ/NY ↔ MV / Nantucket (Weekends)

Rhode Island (Seasonal):

- Providence ↔ Newport



505 Class
4 Vessels
141' x 34'
505 passenger
32 knots service



Vineyard Class
2 Vessels
95' x 28'
149 passenger
28 knots service

Rhode Island Class
1 Vessel
65' x 24'
149 passenger
28 knots service



New Commodore Class
150' x 40'
600 Passenger
35 knot service
One in operation
One under construction



Overview

- Together with its predecessors delivering raw materials across the Great Lakes since 1883.
- Privately held since 1987.
- Headquartered in Cleveland, Ohio (Middleburg Heights).
- Largest privately held U.S.-Flag fleet on the Great Lakes.
- Significant depth of experience and in-house capabilities.
- We are proud of our many achievements, including our safety record, our customer service, customer relations, our Corporate culture, the strength and diversity of our team, our ability to be flexible and adapt, and our pioneering nature.





Interlake

MARITIME SERVICES



Legacy Interlake Ops (ISS)

- Seamen – Union (MEBA/USW)
- 10 - Vessels
 - 8 Owned & Operating
 - 1 Under Construction
 - 1 LT Layup (Sherwin)
- Cargoes
 - Iron Ore
 - Coal
 - Stone
 - Salt



1 – Tug Barge Unit

- Barge – Pere Marquette
- Tug - Undaunted



Passenger/Car Ferry

- Vessels
 - SS Badger – Operating
 - SS Spartan – LT Layup
- Seasonal (May-Oct)



Ludington Property

- Stone Dock
- Ferry Terminal

Our Vision

“To evolve and diversify within the transportation industry while promoting an industry leading culture and innovating through technology”

Our Values

**We embrace the values of
Integrity,
Respect,
High Performance and
Accountability.**

Military to Maritime



Interlake Maritime Services has over 50 retired Military working in our company or 21% of the work force.









Company Mission

Interlake's Quality, Safety, Security and Environmental Policy

- To be the premier marine transportation and logistical solutions partner for our customers, The Interlake Steamship Company is committed to meeting the requirements of our customers and stakeholders by operating our fleet of vessels in a safe, environmentally responsible, secure, and efficient manner.
- This is achieved by the implementation of and adherence to a Quality Management System known as the Interlake Management System (IMS). Interlake will comply with applicable rules and regulations by implementing the IMS.
- All personnel within the scope of the IMS are responsible for the quality of their work and processes. The Interlake Steamship Company is committed to continual improvement of the IMS and provides the resources to assist personnel in achieving this Policy.

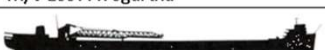
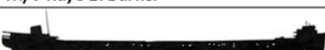

The Interlake Steamship Company

	Re-engined 2010 EGS 2018
	EGS 2016
	EGS 2017
	Repowered 2009 EGS 2015
	Repowered 2016
	#2 Diesel
	Repowered 2006 EGS 2016
	Repowered 2012
	Long Term Lay-up

Interlake Leasing III

	#2 Diesel
--	-----------

Interlake Fleet

- Operate nine ships, one ship in long term lay-up
- Stewart J Cort is Managed for ArcelorMittal (Cleveland Cliffs)
- New Vessel under construction in Sturgeon Bay, WI
- 2006-2016 complete a large upgrade program on existing vessels including conversions from steam to diesel power and installation of Exhaust Gas Scrubbers
- Carry 18-20 million tons of Iron Ore, Limestone, Coal and Salt per season

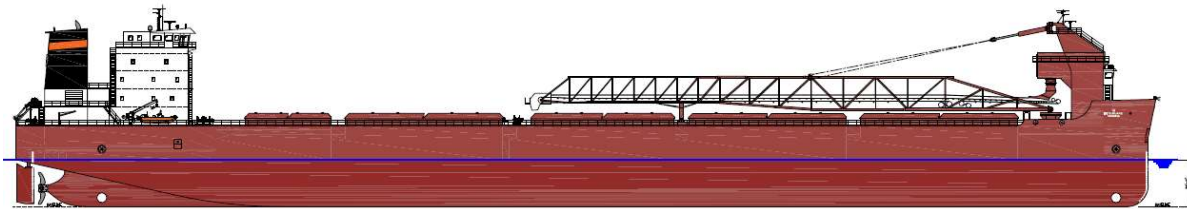

New Vessel

- Being built in Sturgeon Bay, WI
- Delivers in 2022

M/V Mark W. Barker

L.O.A. = 639'-0"

Breadth = 78'-0"

Depth = 45'-0"

Cubic = 878,000ft³

D.W.T = 28,000 LT

Operating Draft = 29'-0"

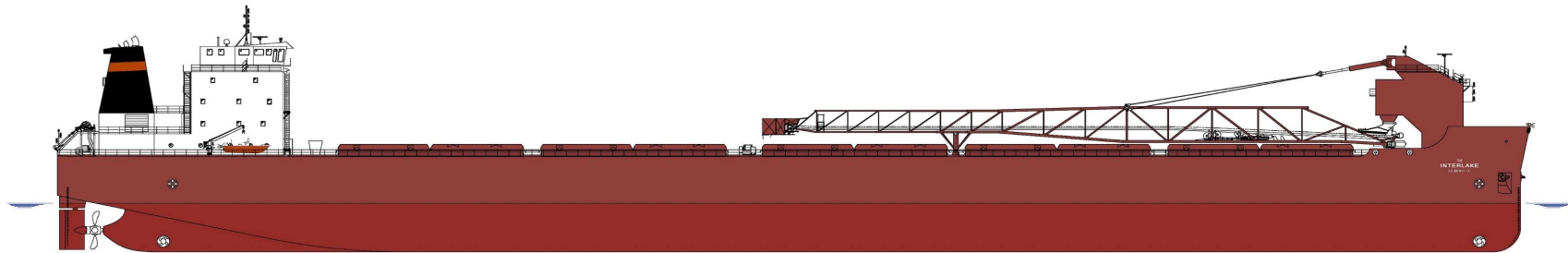

OUTBOARD PROFILE

MAIN PROPULSION EQUIPMENT:

- MAIN ENGINE: TWO (2) EMD, 16-CYLINDER, EACH RATED 3000 kW (4000 BHP) @ 900 RPM
- SHAFT GENERATORS: TWO (2), 2500 kW EACH
- REDUCTION GEAR: ONE (1) LUFKIN TWIN-INPUT/SINGLE-OUTPUT, 7.5:1.0 RATIO
- PROPELLER: ONE (1) 4-BLADE KaMeWa, 18'-0" DIA, CPP
- SHIP SERVICE GENERATOR: CAT C32, 940 kW
- EMERGENCY GENERATOR: CAT C9, 274 kW

UNLOADING EQUIPMENT:

- 260' BOOM w/ 60" BELT, 6,000 LT/HR, TWO (2) X 400 HP DRIVE ASSEMBLIES
- 90" EMS-TECH TUNNEL/LOOP CONVEYOR BELT, TWO (2) X 600 HP VFD DRIVE ASSEMBLIES
- 96" EMS-TECH INNER LOOP BELT
- HOLD GATES: (34) BASKET TYPE, 4'-11" W x 8'-4" L GATE OPENING
- TWO (2) CATERPILLAR 938M FRONT-END LOADERS

M/V Mark W. Barker

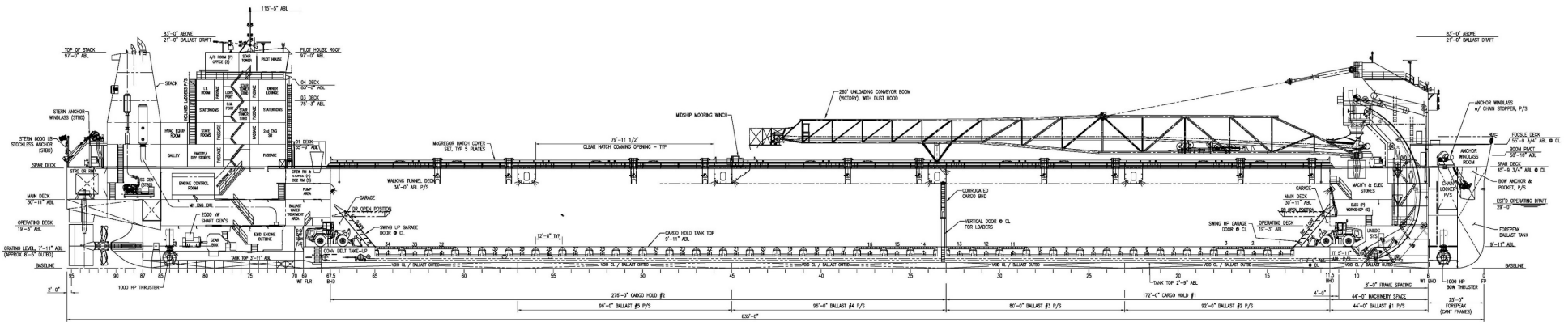

INBOARD PROFILE

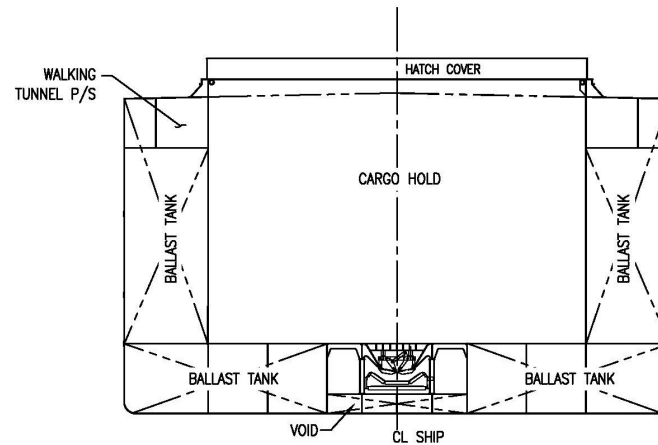

MIDSHIP SECTION
LOOKING FORWARD

Tug Undaunted/Barge Pere Marquette 41

- Cargoes
 - Scrap
 - Armor Stone
 - Pig Iron
 - Bottom Ash
 - Slag
- Steel



Lake Michigan CARFERRY

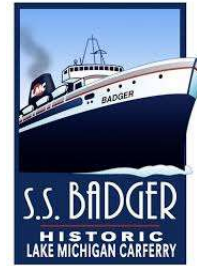

Lake Michigan Car Ferry Routes

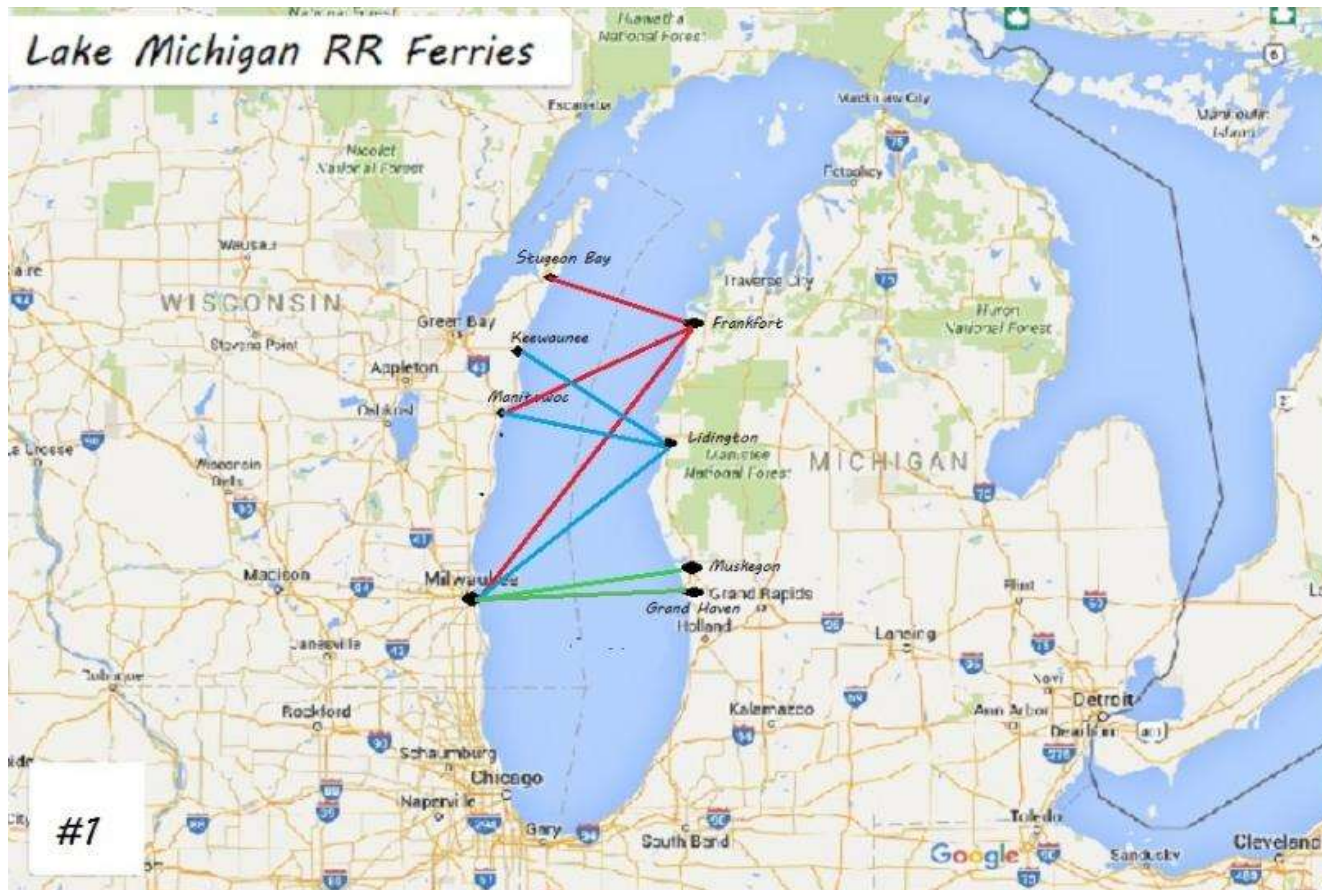

AA – Ann Arbor Railroad

GTW - Grand Trunk Railroad

PM/C&O – Pere Marquette
Railway and then the
Chesapeake and Ohio Railway

CARGOES AT A GLANCE

For The Interlake Steamship Company, iron ore reigns king. It's projected to be more than double the amount of coal or stone for 2021. Salt continues to be a growing commodity for the fleet.



CARGOES AT A GLANCE

- For Interlake Logistics Solutions, scrap steel is expected to be the leading cargo in 2021.
- Ash was the top cargo for 2020, followed closely by aggregate.
- Pig iron is also a strong cargo.



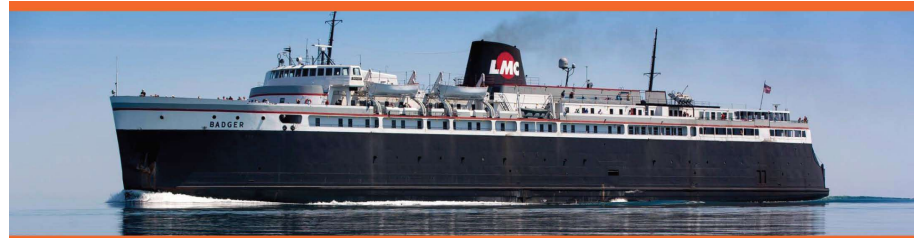

WISCONSIN STATE IMPACT OVERVIEW

INTERLAKE MARITIME SERVICES is a family of companies with nearly 300 years of collective service on the Great Lakes. A family-owned and -led company in its second generation, Interlake Maritime and its more than 50 shoreside employees manage The Interlake Steamship Company, Interlake Logistics Solutions, Lake Michigan Carferry and Interlake Port Services from its corporate headquarters in Middleburg Heights, a suburb of Cleveland, Ohio, and its additional regional offices in Duluth, Minn., and Ludington, Mich. Interlake's commercial fleet moves more than 20 million tons of dry bulk cargo annually, including iron ore, pig iron, coils, slag, scrap, finished steel and project cargos.

THE INTERLAKE STEAMSHIP COMPANY is the largest privately held U.S.-flag fleet on the Lakes. Its nine modernized and efficient freighters carry close to 20 million tons of bulk, free-flowing cargoes annually including iron ore and flux stone for the steel industry, stone for the construction industry, coal for power generation and salt for de-icing needs on roads and highways. The company is currently building its 10th vessel – the M/V *Mark W. Barker* – in Sturgeon Bay, Wisconsin. It is the first Great Lakes bulk carrier built on the Great Lakes in more than 35 years. The 639-foot vessel will be underway in 2022.

INTERLAKE LOGISTIC SOLUTIONS operates the articulated tug-barge *Undaunted-Pere Marquette 41*, a 403-foot workhorse on the Lakes that can carry diverse cargoes that traditional self-unloaders cannot such as large armor stone for break walls, pig iron, scrap, slag, and steel slabs.

LAKE MICHIGAN CARFERRY operates the S.S. *Badger*, the largest cross-lake passenger and car ferry service on the Lakes. Designated a National Historic Landmark, the *Badger* is a key part of US 10 highway connecting the cities of Ludington, Mich., and Manitowoc, Wis. A vital link across Lake Michigan, the *Badger* can accommodate 600 passengers and 180 vehicles, including RVs, motorcycles, motorcoaches, and commercial trucks and oversized load in one single trip.

Since 2010, Interlake has spent more than **\$200 million** at Wisconsin's two largest shipyards: Fraser Shipyards in Superior and Fincantieri Bay Shipbuilding in Sturgeon Bay.

In 2020, Interlake Maritime Services' companies paid more than **\$31 million** in wages to nearly **700** employees, **65** of whom reside in Wisconsin.



CARGOES Interlake Maritimes Services' commercial fleet of **10** vessels is projected to move nearly **20 million** tons in 2021.





WISCONSIN PORTS

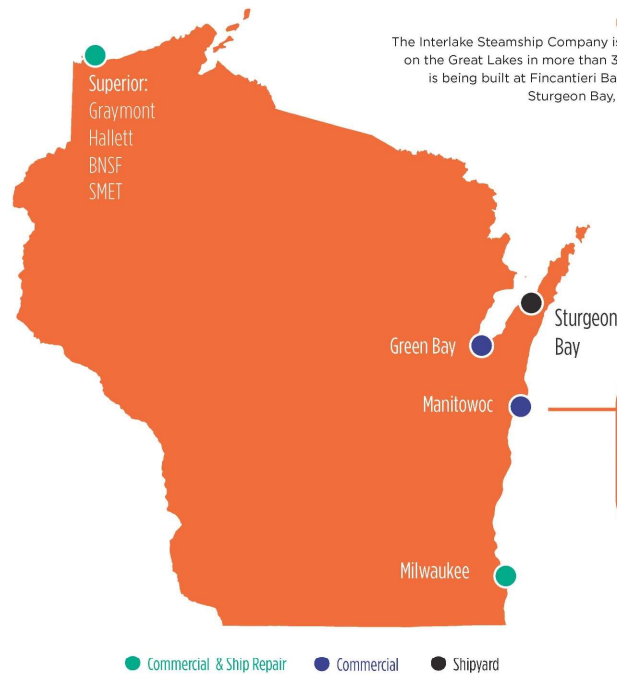

U.S.-CREWED, U.S.-OWNED, U.S.-BUILT

The Interlake Steamship Company is building the first Great Lakes bulk carrier on the Great Lakes in more than 35 years. The 639-foot M/V *Mark W. Barker* is being built at Fincantieri Bay Shipbuilding on the freshwater shores of Sturgeon Bay, Wis. She will be underway in Spring 2022.

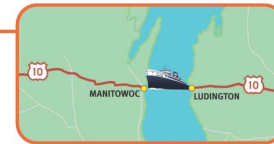

NATIONAL HISTORIC LANDMARK

Lake Michigan Carferry's S.S. *Badger* carries as many as 90,000 passengers and thousands of vehicles in a season of daily voyages between Ludington, MI and Manitowoc, WI.

OUR CUSTOMERS



www.interlakemaritimeservices.com | 440.260.6900 | 7300 Engle Rd, Middleburg Heights, OH 44130

Thank you and GO BADGERS!

